

STAINLESS STEEL ASTM A182, ASA 300lb Raised Face Slip On Flanges

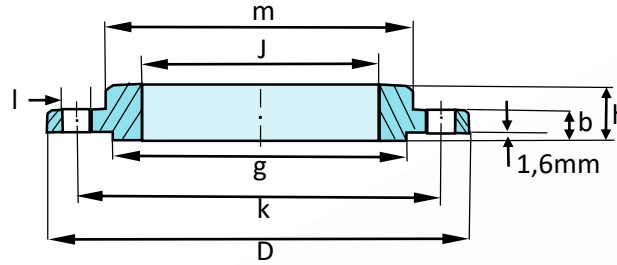

Pipe	Flange					Hub	Raised face	Drilling template		Weight	Stock standard			
	Nom. size	O.D.1	D	J	b	h	m	g	l		k	No. of holes	kg/pce	ASTM 304L
in.	mm	mm	mm	mm	mm	mm	mm	mm	mm	mm				
0.50in	21.30	95.30	22.30	14.20	22.30	38.10	35.00	15.70	66.50	4	0.64	●	●	
0.75in	26.70	117.30	27.70	15.70	25.40	47.70	42.90	19.00	82.50	4	1.12	●	●	
1.00in	33.40	123.90	34.50	17.50	26.90	53.80	50.80	19.00	88.90	4	1.36	●	●	
1.25in	42.20	133.30	43.20	19.00	27.00	63.50	63.50	19.00	98.40	4	1.80	●	●	
1.50in	48.30	155.40	49.50	20.60	30.20	69.80	73.10	22.30	114.30	4	2.49	●	●	
2.00in	60.30	165.10	62.00	22.30	33.20	84.00	91.90	19.00	127.00	8	2.87	●	●	
2.50in	73.00	190.50	74.70	25.40	38.10	100.00	104.80	22.20	149.20	8	4.40	●	●	
3.00in	88.90	209.50	90.70	28.40	42.90	117.30	127.00	22.30	168.10	8	5.85	●	●	
4.00in	114.30	254.00	116.10	31.70	47.70	146.00	157.20	22.30	200.10	8	9.61	●	●	
5.00in	141.30	279.40	143.80	35.10	50.80	177.80	185.70	22.40	235.00	8	12.30	●	●	
6.00in	168.30	317.50	170.70	36.50	52.30	206.20	215.90	22.30	269.70	12	15.60	●	●	
8.00in	219.10	381.00	221.50	41.10	61.90	260.30	269.70	25.40	330.20	12	24.20		●	
10.0in	273.00	444.50	276.40	47.60	66.70	320.70	323.80	28.60	387.30	16	37.10	●	●	
12.0in	520.70	520.70	327.20	50.80	73.00	374.60	381.00	31.70	450.80	16	50.00	●	●	